

# App Shell Properties -- Akash Rajput

## App Shell?

It's the components & functionality that are common throughout the experience. It can be header, top-level tabs, L1 navigation, footer, etc. Usually, the app shell components are specific to a single canvas, because it's part of what makes those experience unique.

## Types of App shell

### 1. Workspace App Shell UI

Allows you to create new workspace experience

### 2. Portal App Shell UI

Allows you to create a new Portal experience

## UX Page Properties Records

The records that contain the metadata for the App Shell configuration

## Types of Page Properties

- **Global:** With an (empty) route it will affect ALL pages in your workspace or portal.
- **Page-specific:** With a route definition

**There are specific names that one will use for each App Shell configuration**

**chrome\_header:** Header Configuration

**chrome\_footer:** Footer configuration

**chrome\_toolbar:** Navigation configuration

**global\_search\_configurations:** Contains references to global search configuration to be consumed by global search component

**chrome\_tab:** Tabs configuration

**chrome\_main:** Performance-related configuration settings

## Header Configuration

Create **chrome\_header** *UX Page Property Record* if you need to add a header to your experience. Inside header config, you can set up **private & public** pages configurations

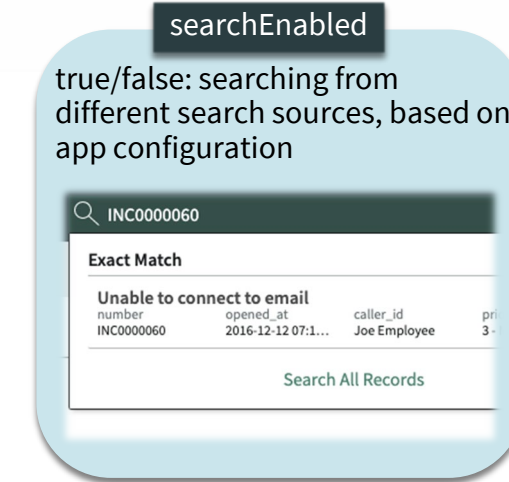
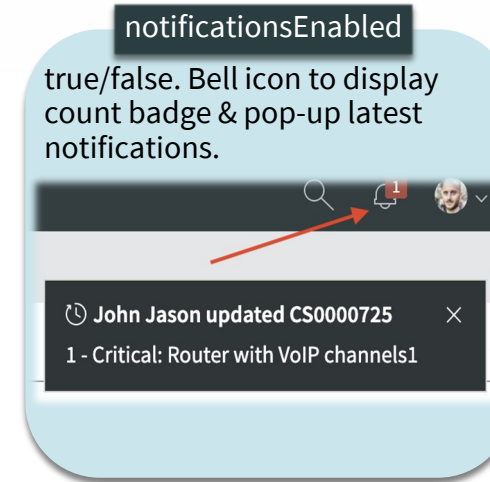
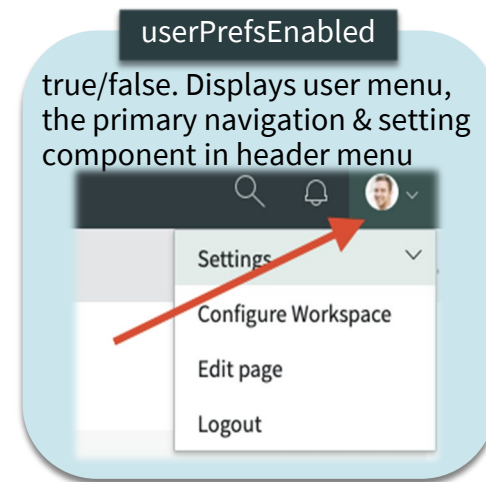

## Footer Configuration

Create **chrome\_footer** *UX Page Property Record* if you need to add a footer to your experience. It has 2 sections; Footer Topbar & Footer bar. To define link in footer, use **chrome\_linkset** property



```
{"linkset_group": [
  { "heading": {
    "type": "text",
    "hasIcon": false,
    "icon": {},
    "label": "Leadership",
    "link": {} }, ...
  }
]}
```

## Navigation Configuration

Create **chrome\_toolbar** *UX Page Property Record* if you need to add a left-side navigation to your experience.

**JSON Objects:**

**id:** string – Defined the button id, **label:** object -- Defines the button value, **icon:** string – Defined the icon displayed, **viewportinfo:** object – Contains viewport info, **group:** string – Options: top/bottom – Defined button placement group – top vs bottom

## Search Configuration

There are 2 main app settings for search:

**global\_search\_configuration** → globalSearchViewConfigId, points to Global Search configuration record

**globalSearchDataConfigId** → points to Search Application config record

## Main Configuration

Create **chrome\_main** record to configure performance setting for your experience.

Performance related configuration settings:

**maxCachedPageCount** → Default value: 30

**maxActivePageCount** → Up to n primary tabs open in DOM. Opening more tabs will re-render them each time. Works in workspace shell. Default value: 10

**timeLeftWarning** → Default Value: 15. Client-side session timeout warning before session